

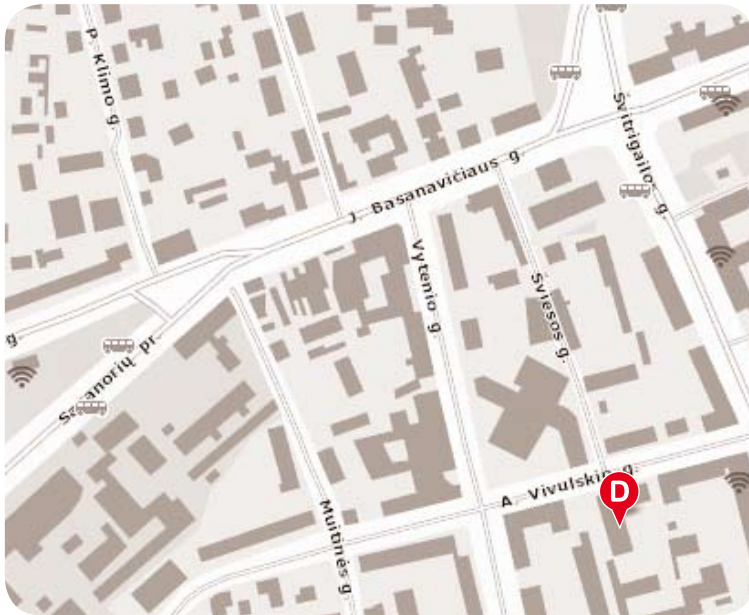

Rankenélés
Kabliukai, pakabos
Kojytės



Mūsų prekybos taškai:

1. UAB „DARVAL“
Vivulskio g. 18
LT-03115 Vilnius

furnitūra:
tel. +370 5 2643940
faks. +370 5 2643941

plokštė:
tel./faks. +370 5 2643942

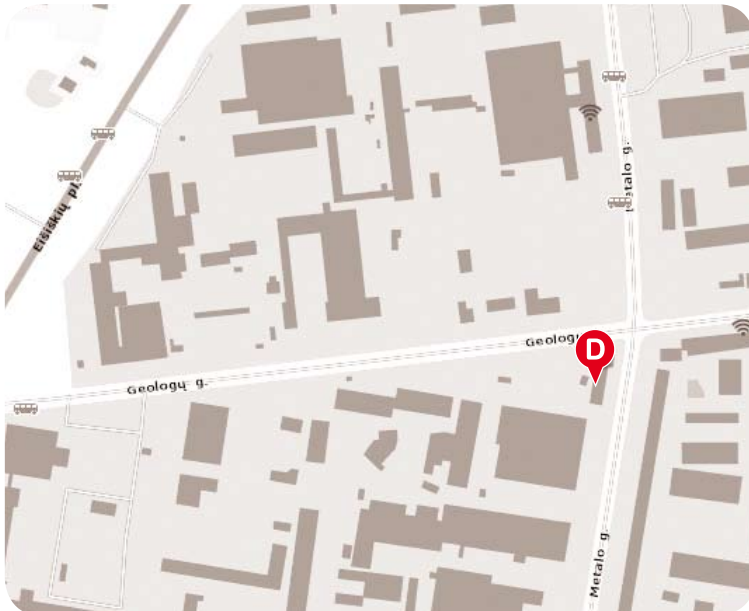

2. UAB „DARVAL“
Metalo g. 11/10
LT-02190 Vilnius

tel. +370 5 2661303
faks. +370 5 2661300

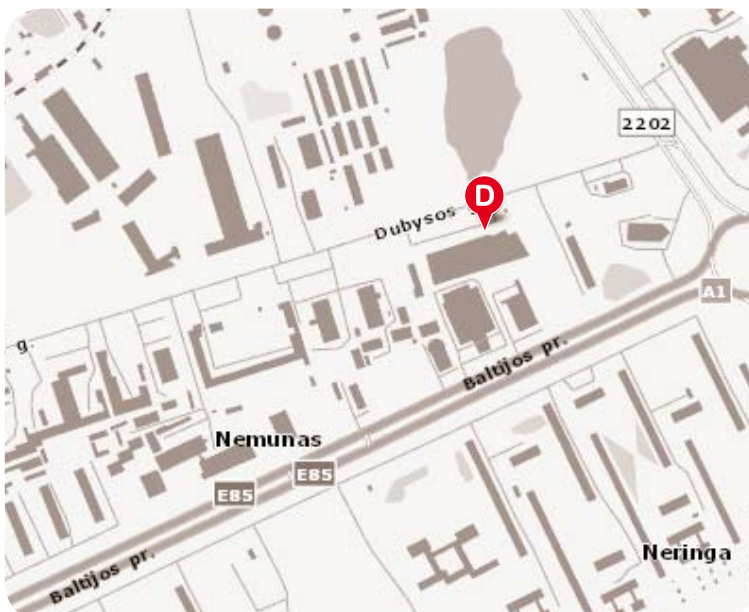

3. UAB „DARVAL“
Dubysos g. 72
LT-94107 Klaipėda

tel./faks. +370 46 345756

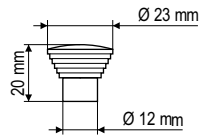

Kodas	Spalva
GAT/GA09	G06, G08

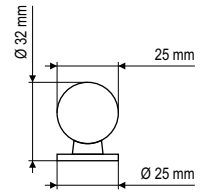

Kodas	Spalva
GAT/GN32	G03, G04, G06, G08

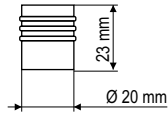

Kodas	Spalva
GAT/GA27	G06, G08

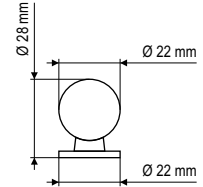

Kodas	Spalva
GAT/GN33	G04, G06, G08

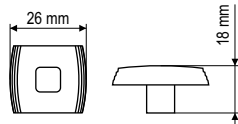

Kodas	Spalva
GAT/GG14	G06, G08

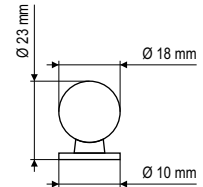

Kodas	Spalva
GAT/GN34	G04, G06, G08

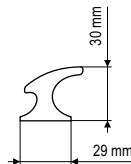

Kodas	Spalva
GAT/GN06	G04, G06, G08

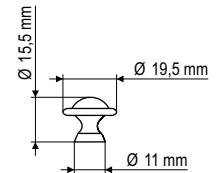

Kodas	Spalva
GAT/GP51	G03, G04, G06

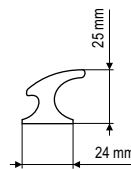

Kodas	Spalva
GAT/GN07	G04, G06, G08

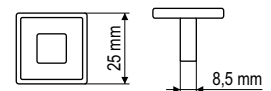

Kodas	Spalva
GAT/GR10	G06, G08

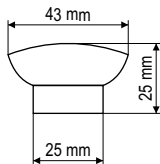

Kodas	Spalva
GAT/GN66	G04, G06, G08

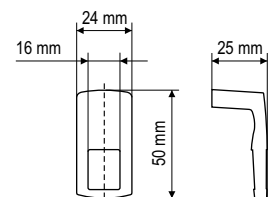

Kodas	Spalva
GAT/RG08	G04, G08

RANKENĖLĖS (VIENGUBO TVIRTINIMO)

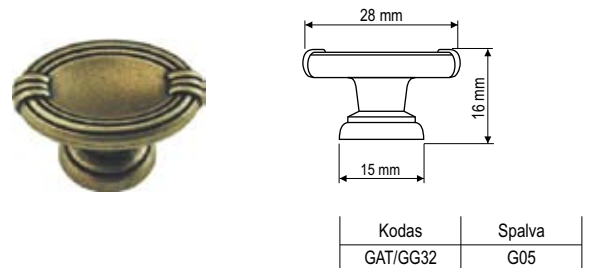
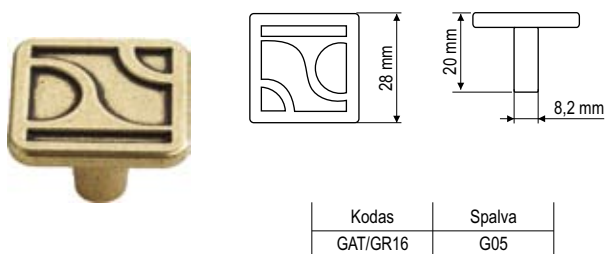
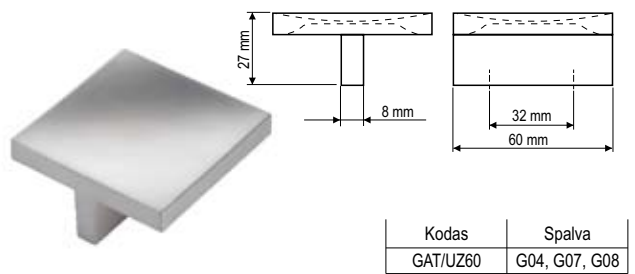
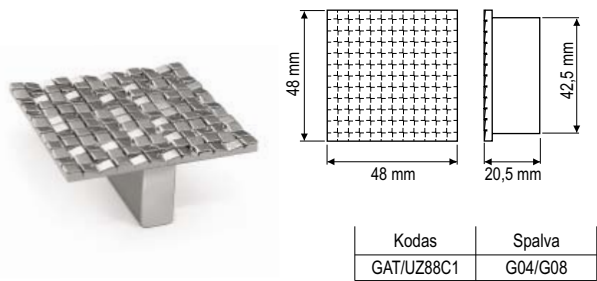
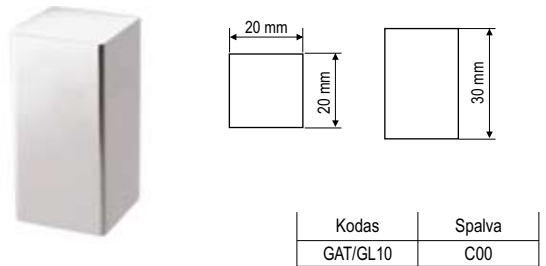
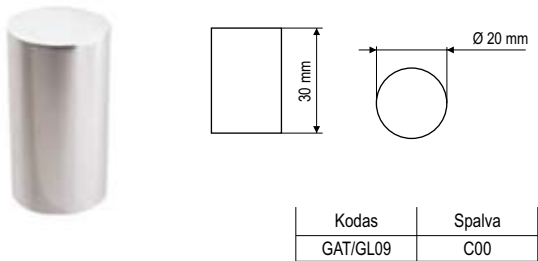
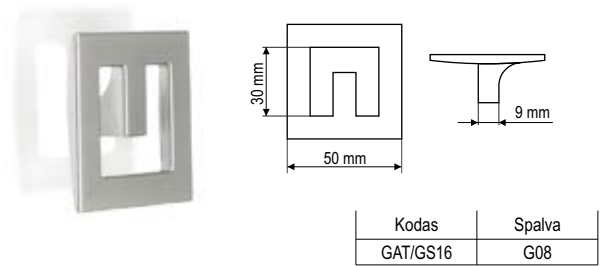
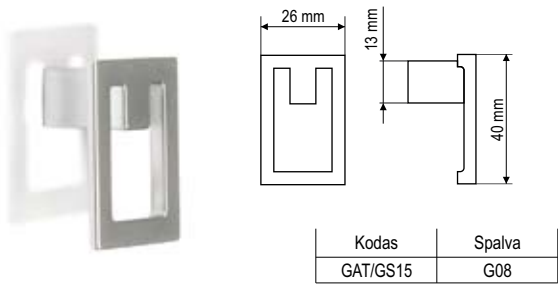
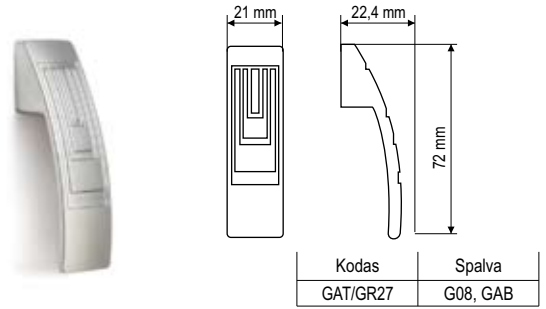
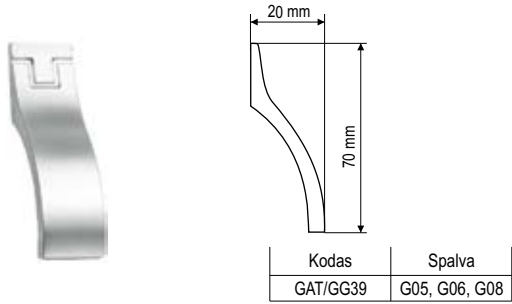
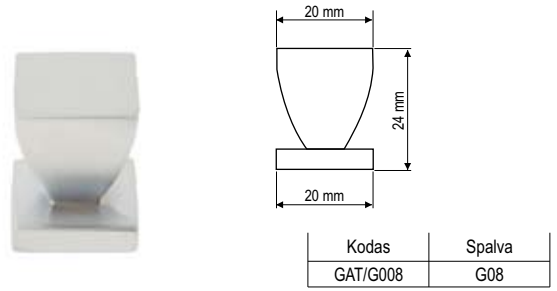
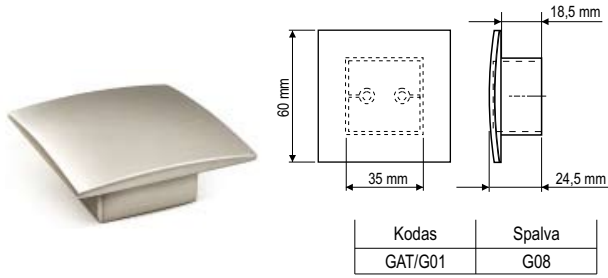

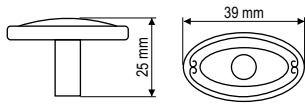

Kodas	Spalva
GAT/GG12	G05

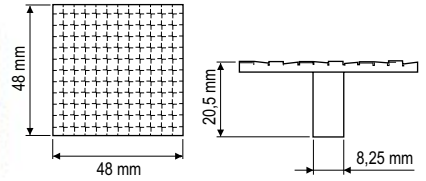

Kodas	Spalva
GAT/UZ88	GAB

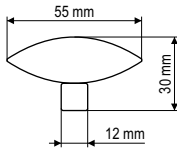

Kodas	Spalva
GAT/GG19	G05

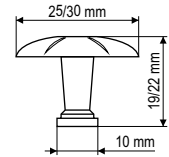

Kodas	Spalva
GAT/GW01	G05

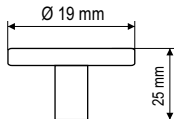

Kodas	Spalva
GAT/GG29	G05

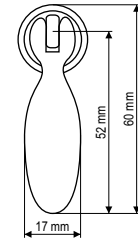

Kodas	Spalva
GAT/KR31	G05

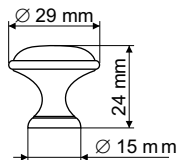

Kodas	Spalva
GP19MLK	GAB

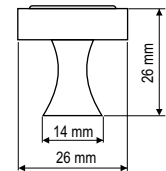

Kodas	Spalva
GAT/GP01	G07

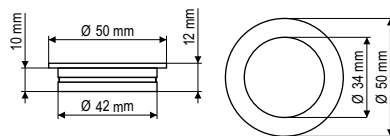

Kodas	Spalva
GAT/MD01	G03, G04, G06, G08

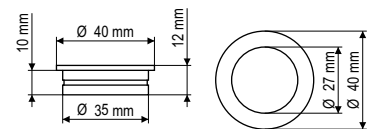

Kodas	Spalva
GAT/MD02	G04, G06, G08

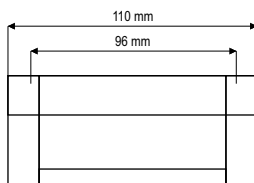
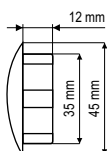

Kodas	Spalva
GAT/JA08	C00/G08

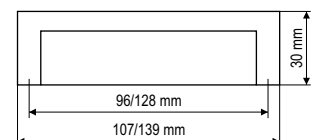
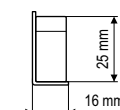

Kodas	Spalva
GAT/JN50	G04, G08

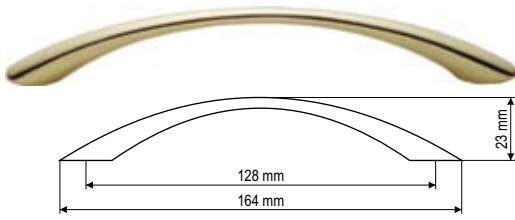

Kodas	Spalva
GAT/UP81	G03, G04, G06, G07, G08, G30

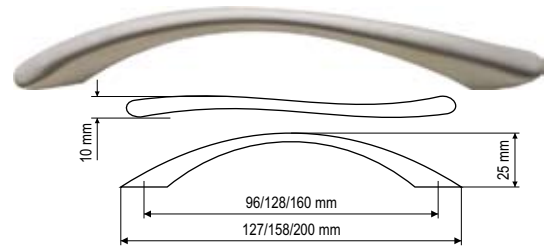

Kodas	Spalva
GAT/UN83	G03, G04, G06, G08

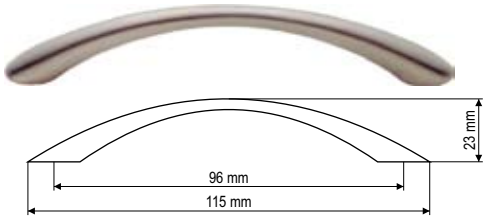

Kodas	Spalva
GAT/UP82	G03, G04, G06, G08, G30

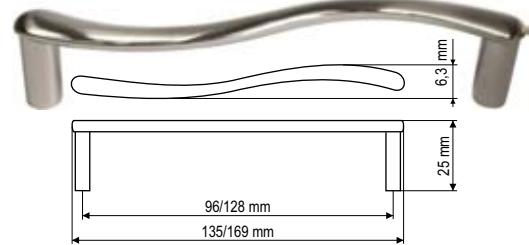

Kodas	Spalva
GAT/UN43	G04, G06, G08

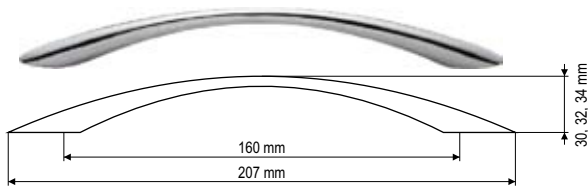

Kodas	Spalva
GAT/UP85	G06, G08

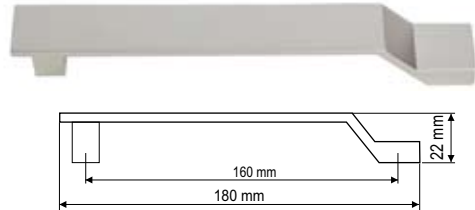

Kodas	Spalva
GAT/U011	G08

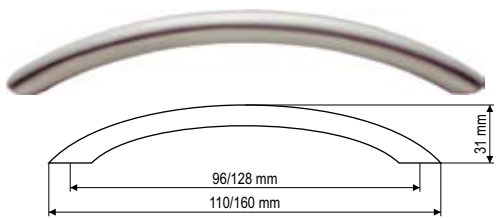

Kodas	Spalva
GAT/UN91	G03, G04, G06, G08, G30

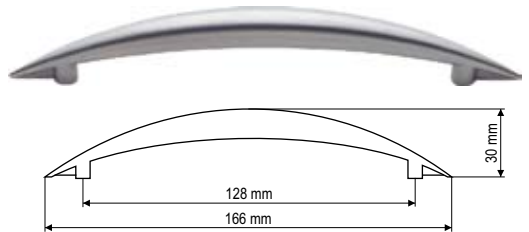

Kodas	Spalva
GAT/US25	G03, G04, G06, G08

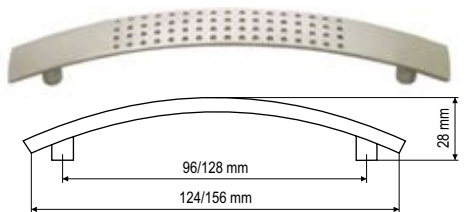

Kodas	Spalva
GAT/UN87	G03, G04, G06, G07, G08

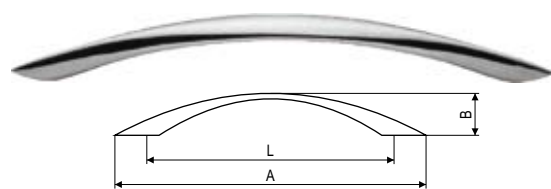

L=192 mm, A=225 mm, B=30 mm
L=128 mm, A=164 mm, B=25 mm
L=96 mm, A=127 mm, B=24 mm

Kodas	Spalva
GAT/US26	G04, G06, G08

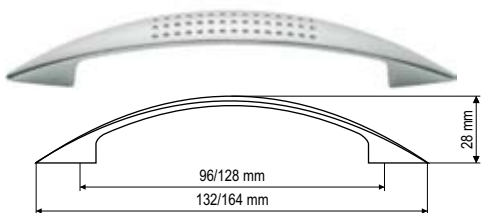

Kodas	Spalva
GAT/UN88	G03, G04, G06, G08

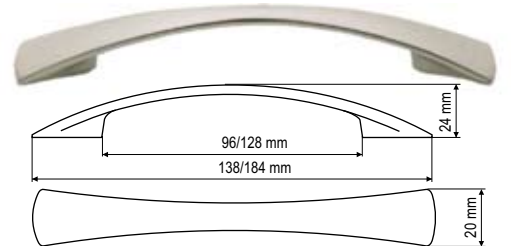

Kodas	Spalva
GAT/UN90	G03, G04, G06, G07, G08

RANKENĖLĖS (DVIGUBO TVIRTINIMO)

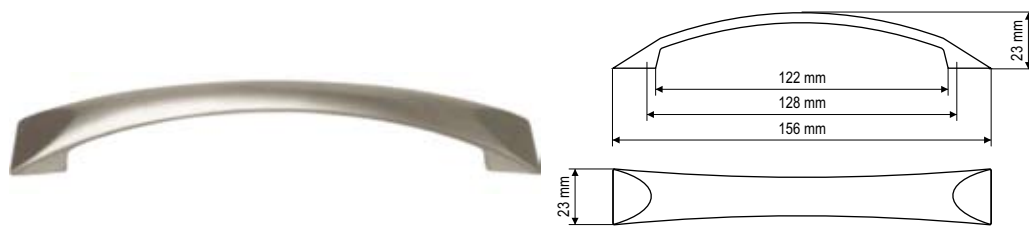

Kodas	Spalva
GAT/UN54	G04, G07, G08



Kodas	Spalva
GAT/UN13	G08



Kodas	Spalva
GAT/UN14	G03, G04, G06, G08

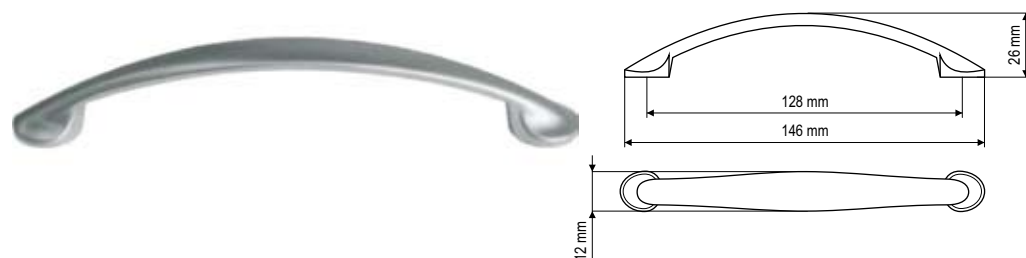

Kodas	Spalva
GAT/UN51	G04, G06, G08



Kodas	Spalva
GAT/UZ92	G04, G08



Kodas	Spalva
GAT/U009	G08

RANKENĖLĖS (DVIĖUBO TVIRTINIMO)

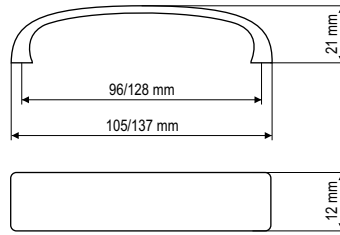

Kodas	Spalva
GAT/UN45	G08

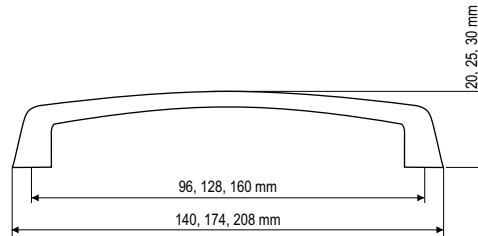

Kodas	Spalva
GAT/UN48	G08

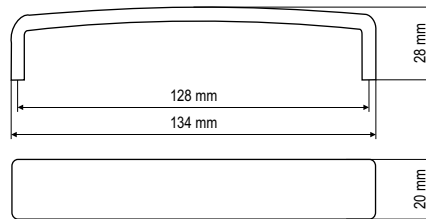

Kodas	Spalva
GAT/UN94	G08

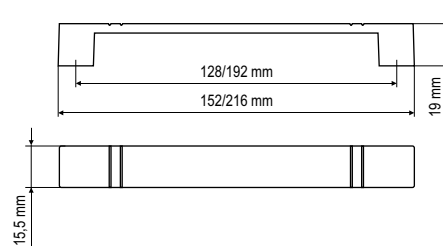

Kodas	Spalva
GAT/UN49	G08

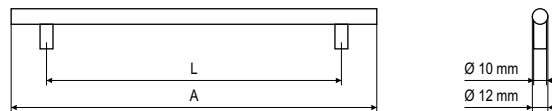

*Užsakant nurodyti spalvą ir žingsnį

L, mm	96	128	160	192	256	288	320	352	384	416	512	544
A, mm	156	188	220	272	356	368	400	432	464	496	592	624

Kodas	Spalva
G/RE10*	G04, G06, G07, G08

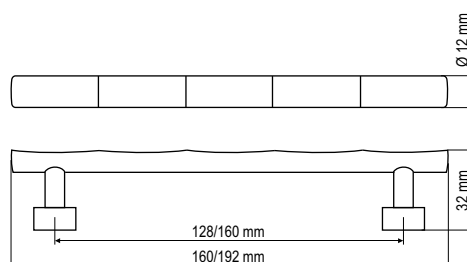

Kodas	Spalva
GAT/RE16	G04/G08

RANKENĖLĖS (DVIGUBO TVIRTINIMO)

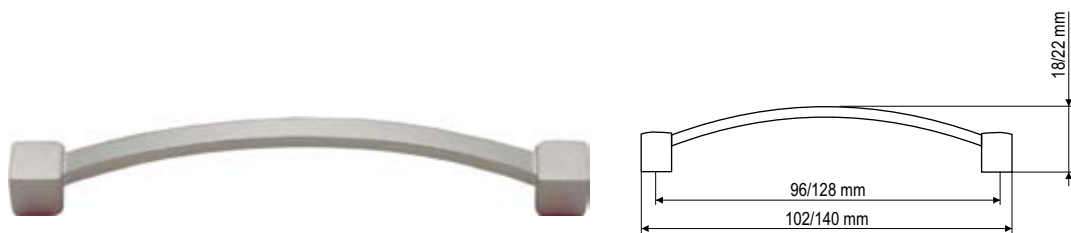

Kodas	Spalva
GAT/UN96	G04, G06, G08



Kodas	Spalva
GAT/UG39	G04, G05, G08

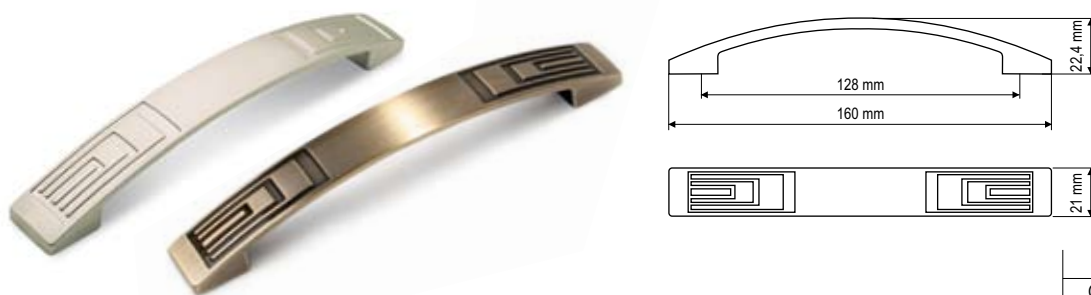

Kodas	Spalva
GAT/UR27	G08, GAB



Kodas	Spalva
GAT/US29	G04, G06

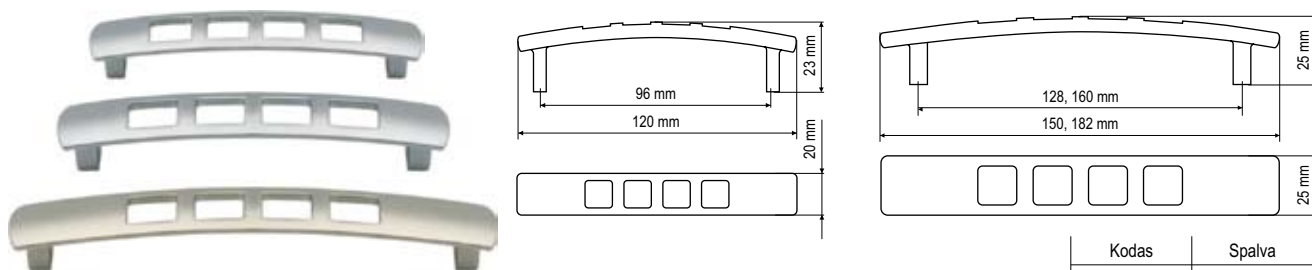

Kodas	Spalva
GAT/RR08	G04, G08



Kodas	Spalva
GAT/UZ18	G08

RANKENĖLĖS (DVIĞUBO TVIRTINIMO)

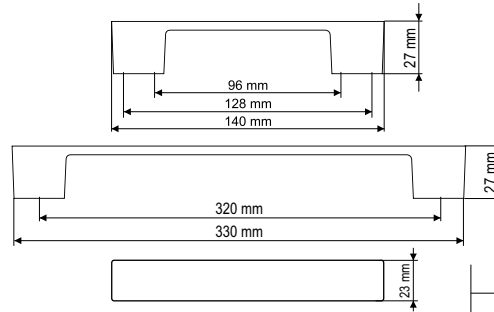

Kodas	Spalva
GAT/UU25	G08

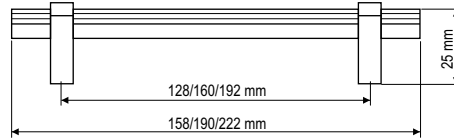

Kodas	Spalva
GAT/RU20	C00/G04

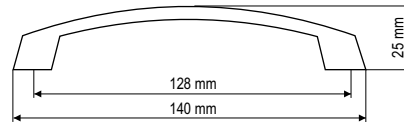

Kodas	Spalva
GAT/UN17	G06, G07, G08

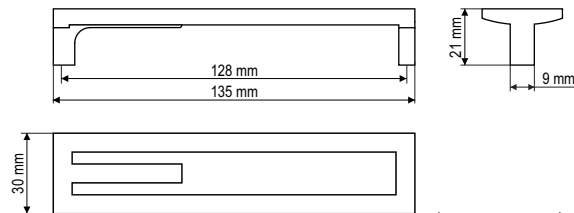

Kodas	Spalva
GAT/US15	G08

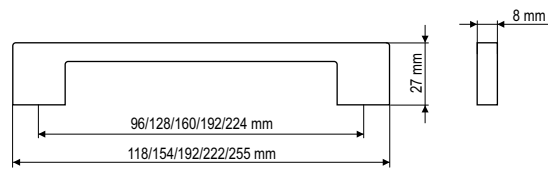

Kodas	Spalva
GAT/E75	G08

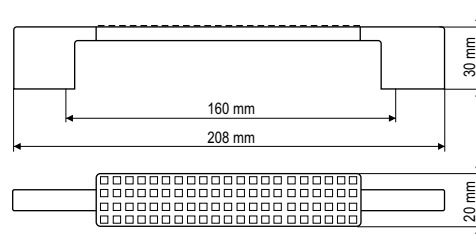

Kodas	Spalva
GAT/U004	G08

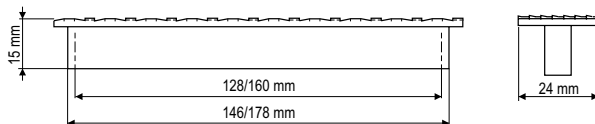

Kodas	Spalva
GAT/UZ88E1	G04/G08

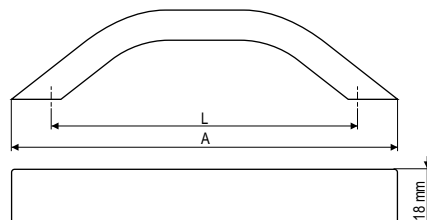

L, mm	128	160	192	224	256	288	320
A, mm	150	182	214	246	278	310	342

Kodas	Spalva
GAT/K24	G07, G08

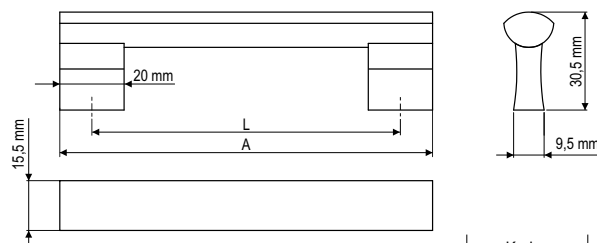

L, mm	128	160	192	320
A, mm	148	180	212	340

Kodas	Spalva
GAT/331B	G08

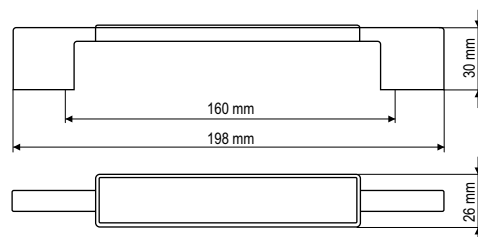

Kodas	Spalva
GAT/UP001WHT	G07

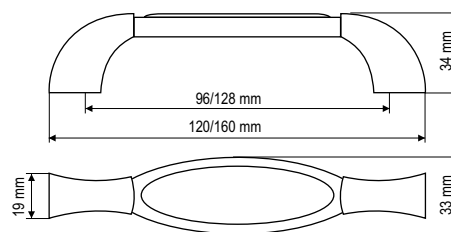

Kodas	Spalva
GAT/UP006WTH	G04

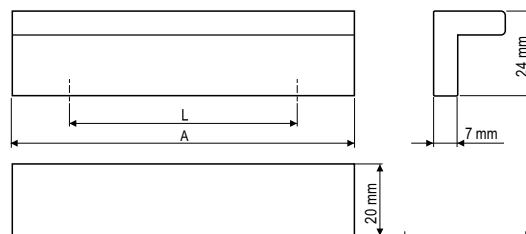

L, mm	96	128	192	224
A, mm	128	160	224	256

Kodas	Spalva
GAT/AA03	C00

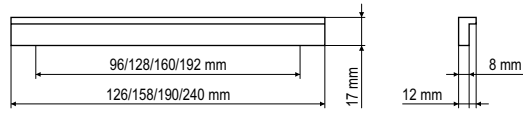

Kodas	Spalva
GAT/UA02	C00

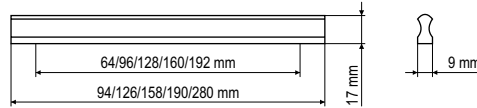

Kodas	Spalva
GAT/UA03	C00

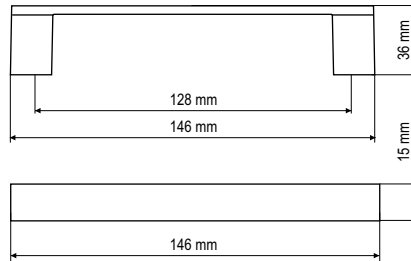

Kodas	Spalva
GAT/UA09	C00

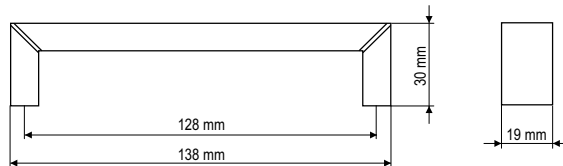

Kodas	Spalva
GAT/UA16	C00

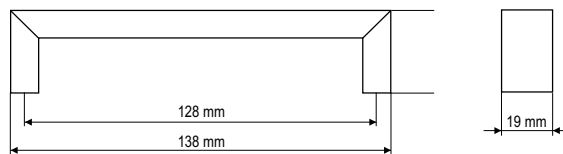

Kodas	Spalva
GAT/UA17	C00

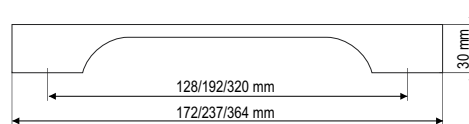

Kodas	Spalva
GAT/UA51	C00

RANKENĖLĖS (DVIGUBO TVIRTINIMO)

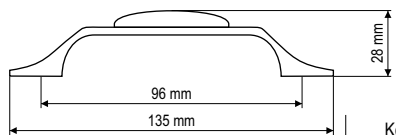

Kodas	Spalva
GAT/UP18	G05

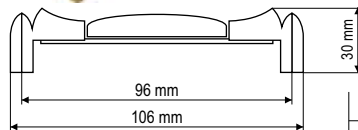

Kodas	Spalva
GAT/UP20	G05

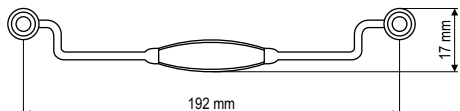

Kodas	Spalva
GAT/UR08	G05

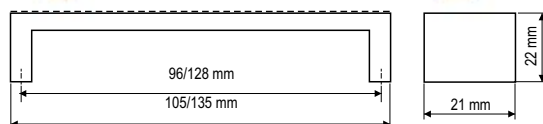

Kodas	Spalva
GAT/UZ88E4	GAB

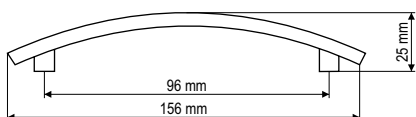

Kodas	Spalva
GAT/JG30	G05

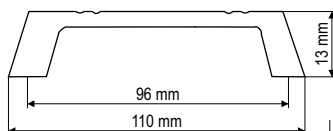

Kodas	Spalva
GAT/JR09	G05

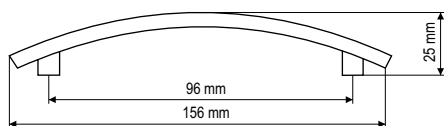

Kodas	Spalva
GAT/JG19	G05

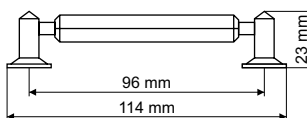

Kodas	Spalva
GAT/JR02	G05

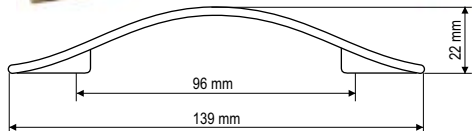

Kodas	Spalva
GAT/JR16	G05

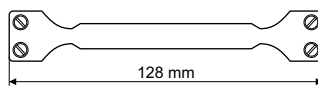
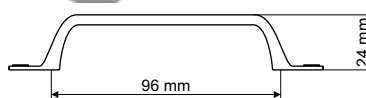

Kodas	Spalva
GAT/US28	G05

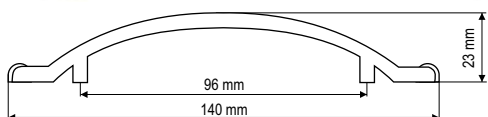

Kodas	Spalva
GAT/JG32	G05

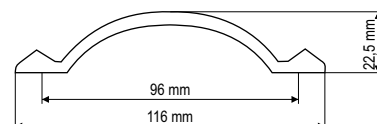

Kodas	Spalva
GAT/JR07	G05

RANKENĖLĖS (DVIŪBŪ TVIRTINIMO)

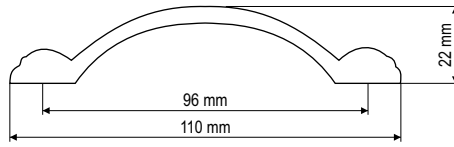

Kodas	Spalva
GAT/UR10	G05

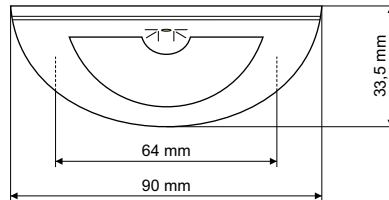

Kodas	Spalva
GAT/UR04	G05

RANKENĖLĖS (VAIKIŠKOS)

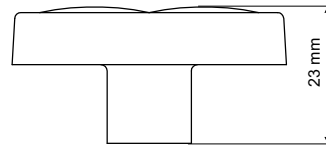
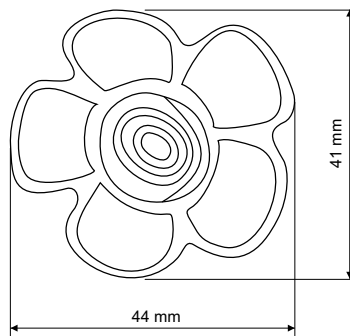

Kodas	Spalva
GAT/GR-G	spalvotos

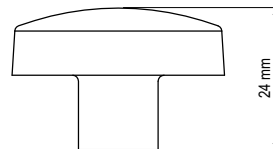
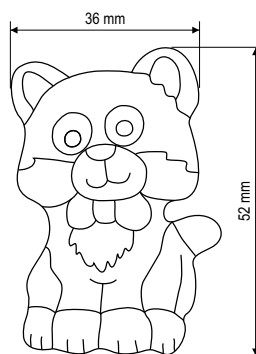

Kodas	Spalva
GAT/GR-I	spalvotos

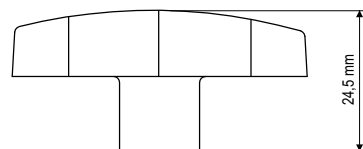
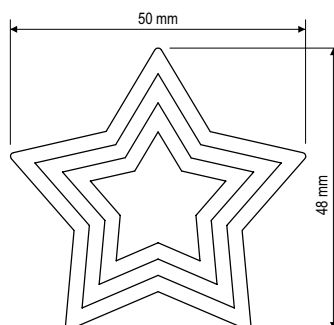

Kodas	Spalva
GAT/GR-H	spalvotos

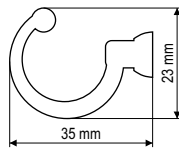

Kodas	Spalva
GAT/WK11	G03, G04, G06, G08

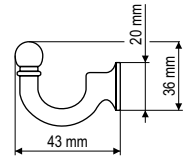

Kodas	Spalva
GAT/WP29	G03, G04, G06, G08

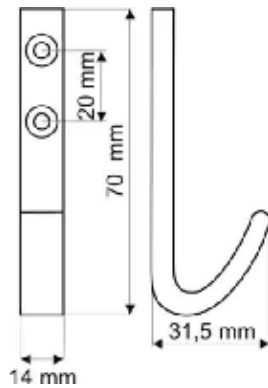

Kodas	Spalva
GAT/WA01	C00

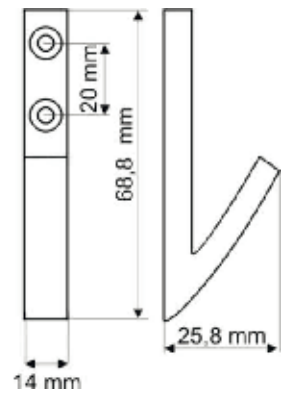

Kodas	Spalva
GAT/WA05	C00

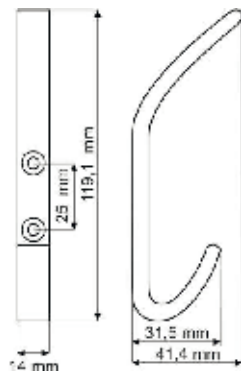

Kodas	Spalva
GAT/WA02	C00

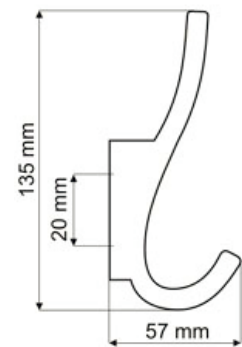

Kodas	Spalva
GAT/RW07	G08

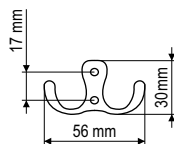

Kodas	Spalva
GAT/WP19	G03, G04, G06, G08, GAB

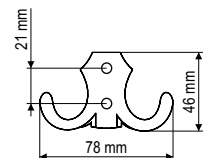

Kodas	Spalva
GAT/WP89	G03, G04, G06, G08, GAB

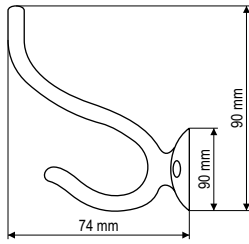

Kodas	Spalva
GAT/WP49	G03, G04, G06

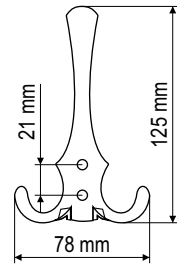

Kodas	Spalva
GAT/WP59	G03, G04, G06, G08, GAB

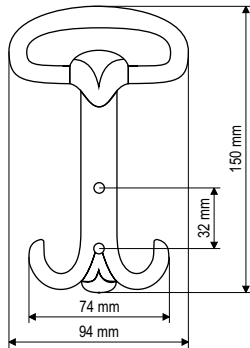

Kodas	Spalva
GAT/WP99	G03, G04, G06, GAB

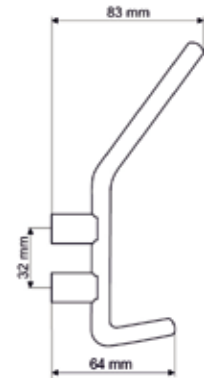

Kodas	Spalva
GAT/WP20	G08

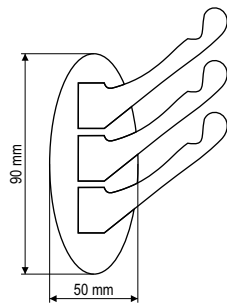

Kodas	Spalva
GAT/WP10	G04, G06, G08

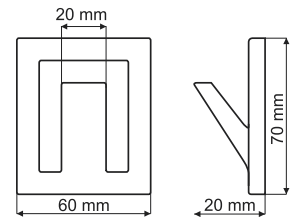

Kodas	Spalva
GAT/WK15	G08

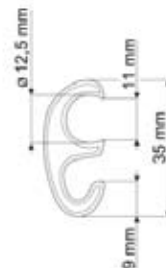

Kodas	Spalva
GAT/WK10	G08

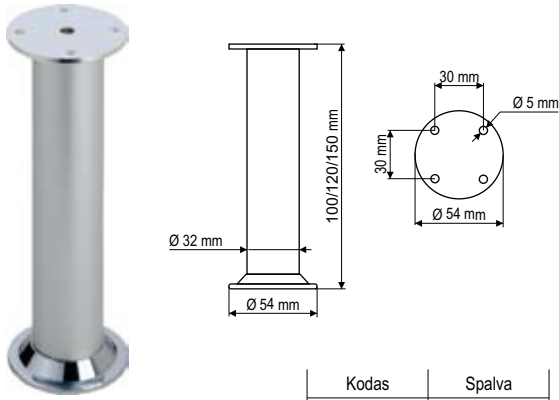

Kodas	Spalva
GAT/NA10	C00

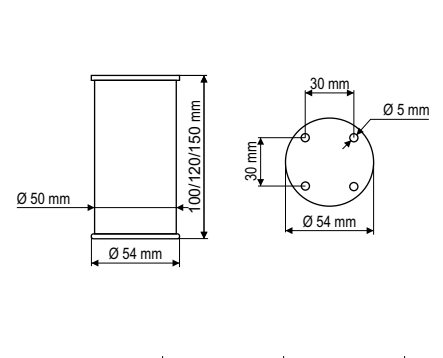

Kodas	Spalva
GAT/NA11	C00

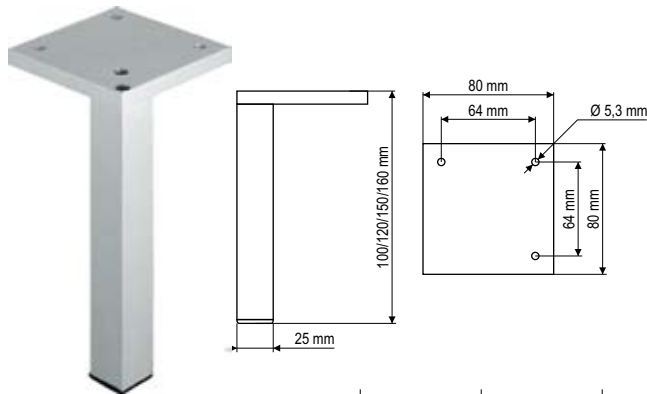

Kodas	Spalva
GAT/NA01	C00

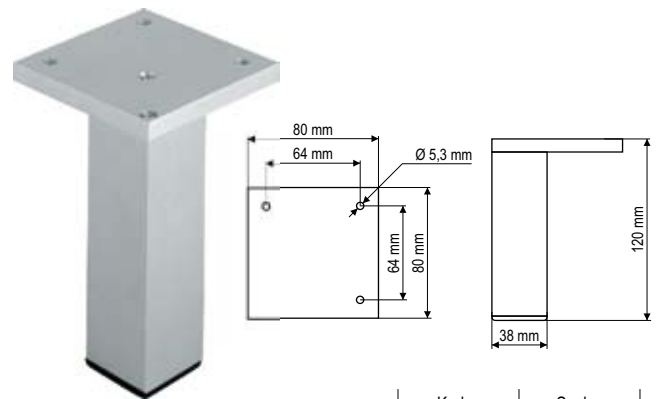

Kodas	Spalva
GAT/NA02	C00

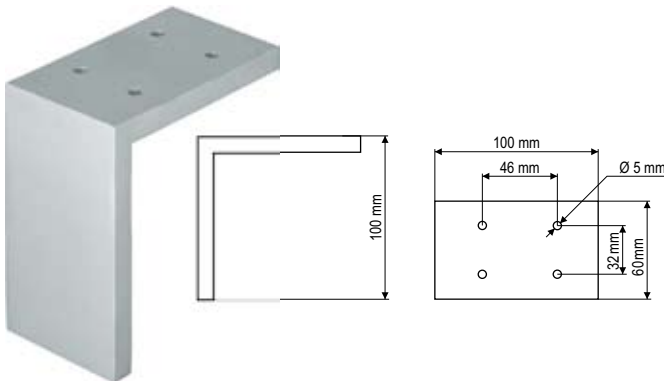

Kodas	Spalva
GAT/NA20	C00

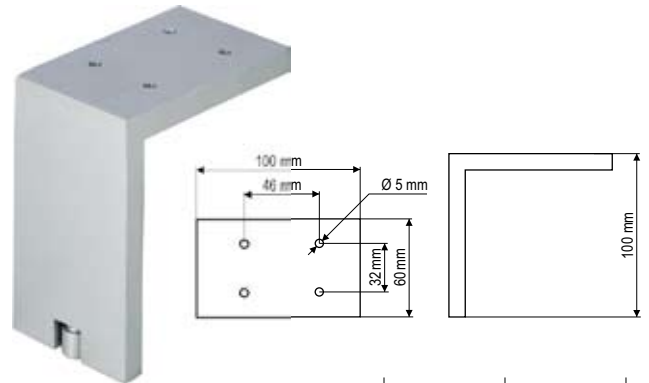

Kodas	Spalva
GAT/NA20/R	C00

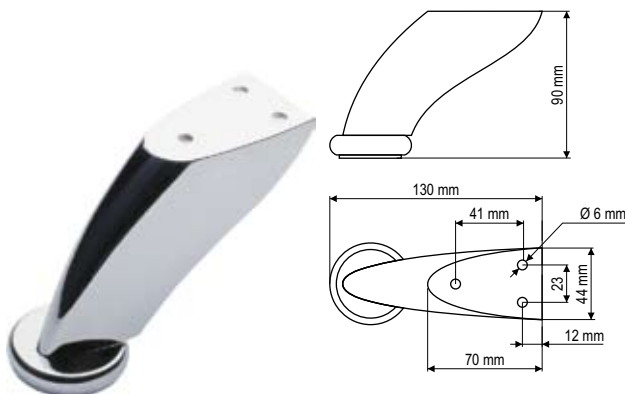

Kodas	Spalva
GAT/NZ02	G04, G06, G08

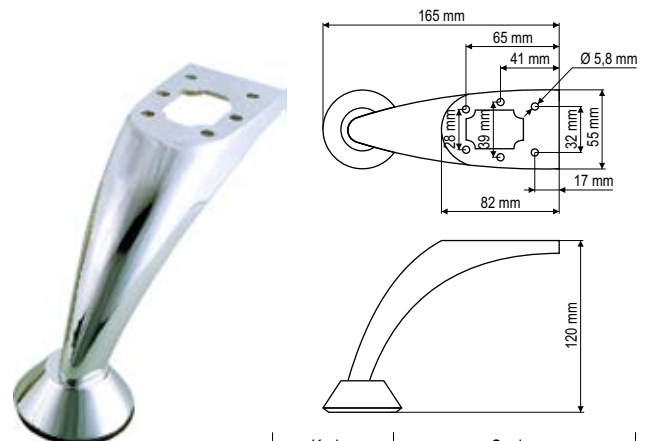

Kodas	Spalva
GAT/NZ07	G03, G04, G06, G08

Kojytė, metalinė, reguliuojama

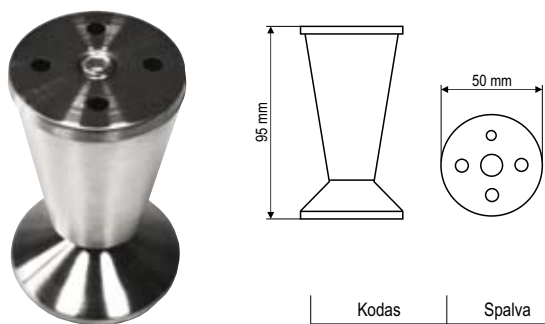

Kodas	Spalva
GAT/NA8010407	G07

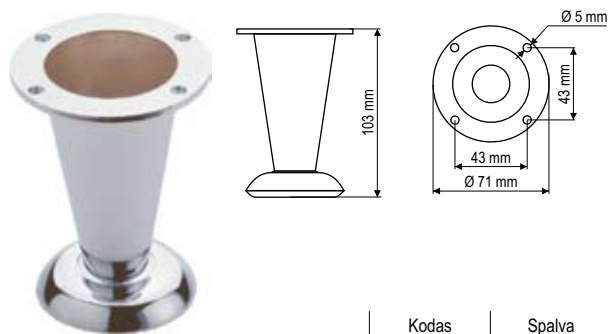

Kodas	Spalva
GAT/NZ09	G04, G06, G08

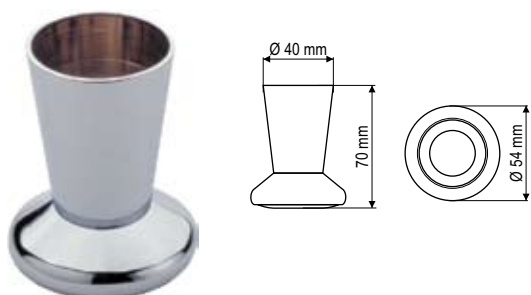

Kodas	Spalva
GAT/NZ06	G03, G04, G06

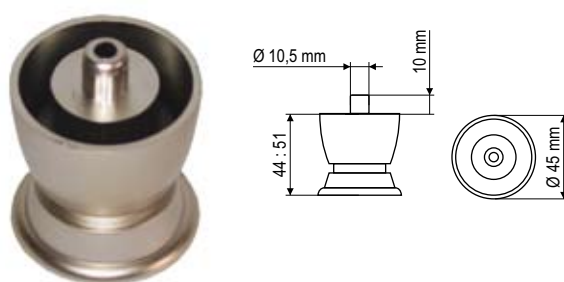

Kodas	Spalva
GAT/PN01	G06, G06/P30, G06/PD30

Kojytė, smailėjanti, reguliuojama, 100÷500 mm

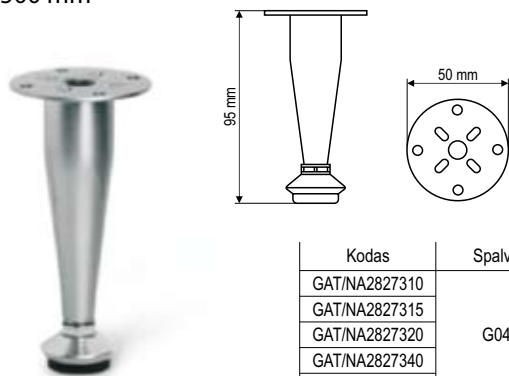

Kodas	Spalva
GAT/NA2827310	G04
GAT/NA2827315	
GAT/NA2827320	
GAT/NA2827340	
GAT/NA2827350	

Kojytė, metalinė, reguliuojama



Kodas	Spalva
GAT/NA810304	G04

Kojytė, kvadratinė, nereguluojama



Kodas	A, mm	H, mm	Spalva
GAT/NA.K-40/60	40x40	60	C00
GAT/NA.K-40/100	40x40	100	
GAT/NA.K-40/150	40x40	150	

Kojytė, medinė, reguliuojama

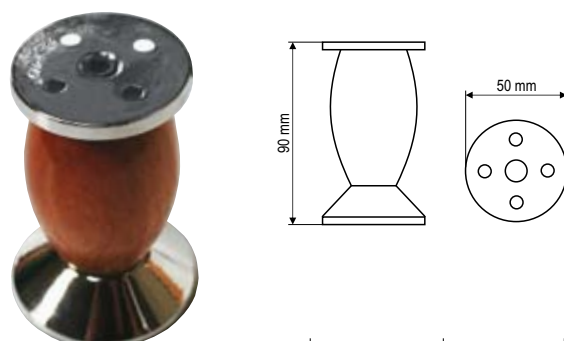

Kodas	Spalva
GAT/NA810502	G04/D10

KOJYTĖS

Kojytė, apvali, reguliuojama

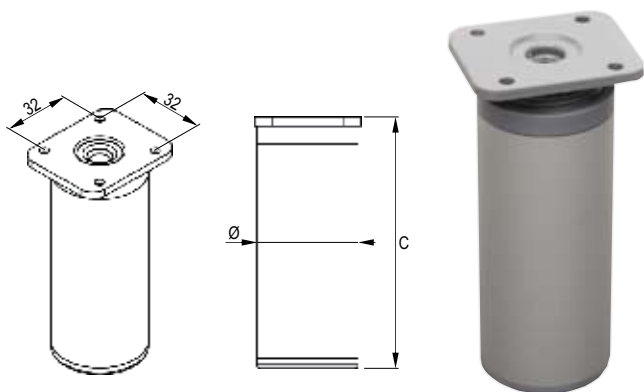

Kodas	Ø, mm	H, mm	Spalva
GAT/NA.6/TPO	40	60	C00
GAT/NA.7/TPO	40	75	
GAT/NA.10/TPO	40	100	
GAT/NA.15/TPO	40	150	
GAT/NA.B6/TPO	60	60	
GAT/NA.B10/TPO	60	100	
GAT/NA.B15/TPO	60	150	

Kojytė, kvadratinė, reguliuojama

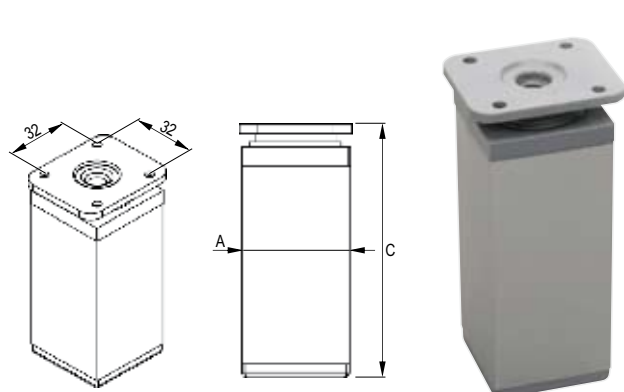

Kodas	A, mm	H, mm	Spalva
GAT/NA.6/TPK	40x40	60	C00
GAT/NA.7/TPK	40x40	75	
GAT/NA.10/TPK	40x40	100	
GAT/NA.15/TPK	40x40	150	
GAT/NA.B6/TPK	60x60	60	
GAT/NA.B10/TPK	60x60	100	
GAT/NA.B15/TPK	60x60	150	

SPALVOS



WTH
baltas
porcelianas



MLK
dramblio kaulo
spalvos
porcelianas



G01



G02



G03



G03

Spalvos kodas	Spalva
G01*	juodas nikelis (vario pagrindas)
G02*	juodas nikelis (žalvario pagrindas)
G03	auksas
GM03*	auksas matinis
G04	chromas
G05, GAB	bronzas
G06	nikelis matinis
G07	pienas
G08	chromas matinis
G09*	juodas poliruotas nikelis
G011*	nepoliruotas nikelis
G30	juoda
C00*	aliuminis
D10	bukas
PD30	alksnis



G04



G05, GAB



G06



G07



G08



G09



G011

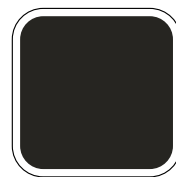

G30



C00



D10



PD30